

Installation guide

flowIQ® 4200 - KWM4220



Contents

1	In general	3
1.1	Intended use and installation scenarios	3
2	Lids	4
3	Installation requirements	5
3.1	In general	5
3.2	Installation precautions	5
3.3	Operating pressure	5
3.4	Flow direction	6
4	flowIQ® 4200 installation	6
4.1	Sediments in the water	7
4.2	Spool piece installation (only applies to 6" and 8" meters)	7
4.3	Split flange installation	8
4.3.1	General flange features and specifications	9
4.3.2	Criss-cross pattern	10
4.3.3	Installing the split flanges on the meter first	10
4.3.4	Installing the flange on the pipeline first	11
4.4	Installation angle	12
4.5	Straight inlet	12
4.6	Flow disturbance and flow cavitation	12
4.6.1	Service connection	12
5	Encoded output installation	13
5.1	Remove the protective cap	13
5.2	Mount the plug	13
5.3	Connect with other electronic reading systems	14
6	FCC Cautions	15
7	ICES/ISED cautions	16

1 In general

Please read this guide carefully before installing Kamstrup water meters.

flowIQ® 4200 meters are used for measuring potable water and all variants are built for submerged conditions.

All meters have an arrow on the side of the meter body, indicating the correct flow direction through the meter.

Restrictions:

- Ensure that the meter is mounted in the correct flow direction
- Ensure correct operating pressure
- Avoid placing the meter in direct sunlight. For meters subjected to any kind of mechanical impact, it is recommended to install a lid on the meter

Disclaimer: In case of reasonably foreseeable misuse or incorrect mounting, Kamstrup's warranty obligations no longer apply.

1.1 Intended use and installation scenarios

flowIQ® 4200 meters are intended for measurements of cold water consumption in industrial environments such as distribution networks and commercial buildings.

Installation scenarios can be in submerged conditions as well.

Ambient temperature range: 35-130 °F.

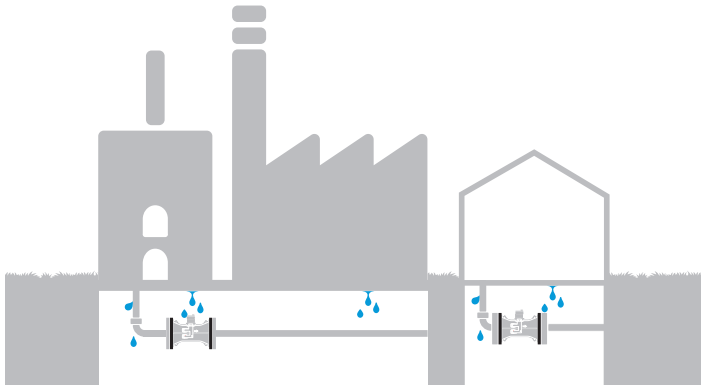

flowIQ® 4200 is suitable for mounting in well applications.

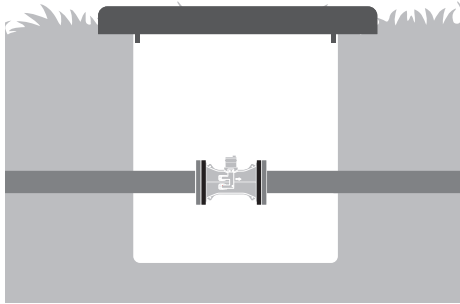

2 Lids

For meters subjected to any kind of mechanical impact, it is recommended to install a lid on the meter.

It protects the meter display from direct sunlight and/or the glass from moderate mechanical impact.

For flowIQ® 4200 meters, it is possible to install a lid.

The lid can be ordered as a separate accessory and will not be attached or mounted on the meter from factory.

- Lid: type no: 66-99-645

Kamstrup requires the installation of a lid if the meter – installed in the intended application – is:

- Installed in public places where unauthorized persons may have access to the meter
- Installed where it may be subject to some kind of mechanical impact
- Installed in direct sunlight (installation of lid is recommended)

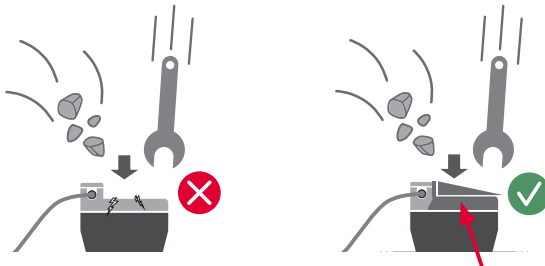

3 Installation requirements

3.1 In general

When installing the meter, it must be orientated correctly in relation to flow direction:

- The flow direction is indicated by an arrow on the side of the meter
- The meter ought to be orientated so that the display is easy to read

3.2 Installation precautions

- The sealing surface of the flanged connection must be clean and level
- Replace gaskets when installing a new water meter
- ALWAYS use new gaskets
- Gaskets in original quality is of crucial importance

3.3 Operating pressure

In order to avoid entrapped air or cavitation in the meter – and to ensure correct measurement under all circumstances – the operating pressure in the pipe installation must always be minimum:

- **20.30 PSI** – split flange meters – flowIQ® 4200

Note: Avoid installation where there is no option for back pressure

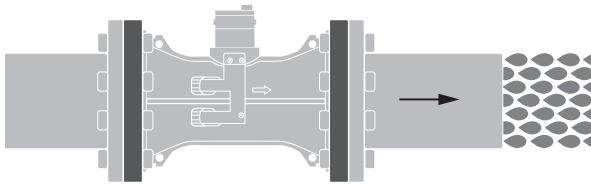

3.4 Flow direction

The meter has an arrow on the side of the meter, indicating the right flow direction through the meter. Only this direction is legal. If flow is registered in the wrong direction, the info code 'REVERSE' is visible in the display, which means that the meter detects reverse flow. The meter calculates the volume in a separate register not verified for billing. Reverse volume is NOT displayed on the meter.

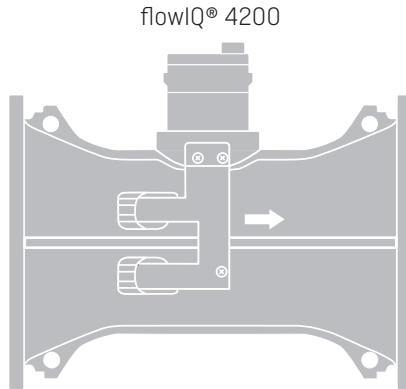

4 flowIQ® 4200 installation

A flowIQ® 4200 meter is delivered with separate coated split flanges in cast iron. Furthermore the 6" and 8" variants of the meter are delivered with spool pieces. Use only the original split flanges and spool pieces from Kamstrup combined with original fiber gaskets. Gaskets can be ordered separately.

Warning! Only lift the meter by using the lifting lugs.

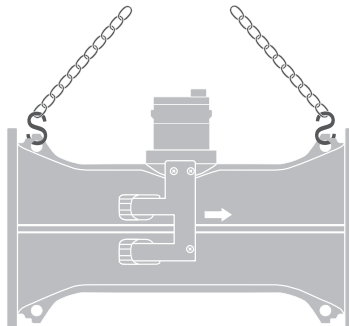

4.1 Sediments in the water

If the water contains sediments Kamstrup suggests to install the meter with the cup facing upwards.

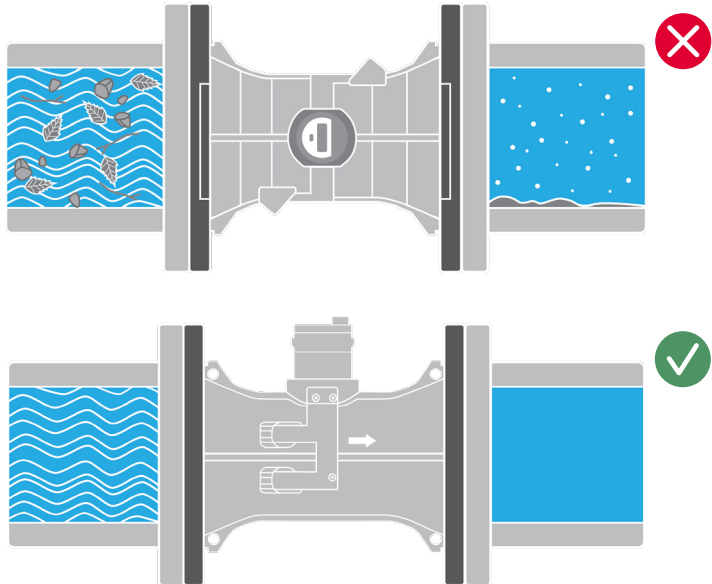

4.2 Spool piece installation (only applies to 6" and 8" meters)

Spool pieces should be mounted on the pipeline flanges first to ensure flexible options in regards to split flange installation on either pipeline or meter.

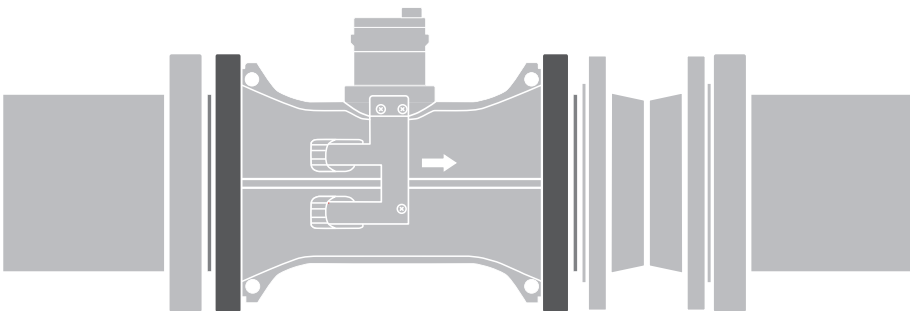

When mounting spool pieces, the described criss-cross pattern procedure applies.

4.3 Split flange installation

Installation sketch:

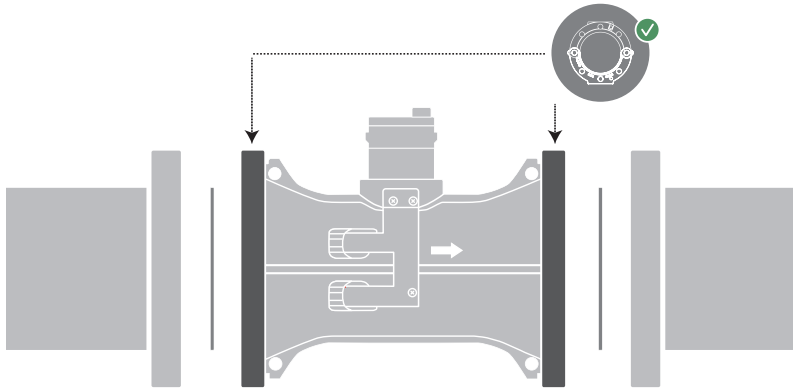

Installing a meter with split flanges gives the option to install the flanges on the pipeline systems first or on the meter itself. Best practice depends on the installation scenarios and the space conditions.

Both options are described below and both installation options require the same procedure for tightening the flange bolts in the described criss-cross pattern.

Tighten all flange bolts according to the described criss-cross pattern with the correct tightening torque. Repeat this procedure three times in total to ensure correct meter installation.

Note! Criss-cross pattern to be repeated three times.

4.3.1 General flange features and specifications

Fixing bolt ¼" bolt and nut:

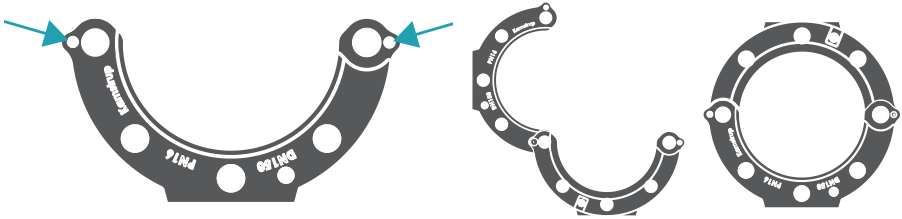

The fixing bolt thread is useful for connecting the two split flange parts during installation. In order to fixate the split flanges a fixing kit is delivered with the meter. The kit contains:

- 4 x 60mm A6 bolts (regardless of split flange size)
- 4 x A6 nuts
- 4 Zip ties

Pushing nut milling:

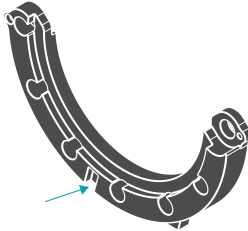

If extra space for the gasket is needed, insert a 7/16" nut in the pushing nut milling, and insert a 7/16" bolt from the opposite side to press and enlarge the gap between the flanges, thus creating space for the gasket.

Lifting lugs

The lifting lugs have two purposes:

- Supporting safe conduct regarding meter installation when lifting
- Fixating the split flanges on the meter

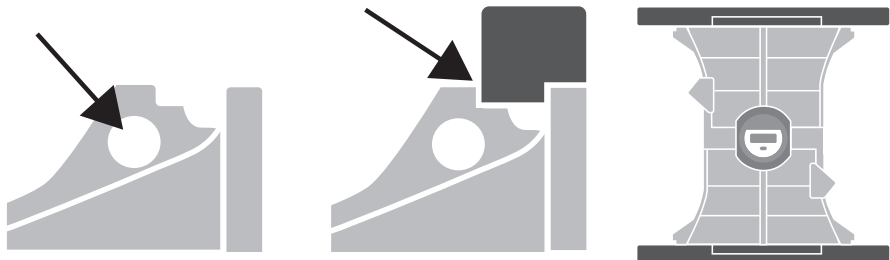

4.3.2 Criss-cross pattern

Tighten all flange bolts in a criss-cross pattern according to the correct tightening torque. Repeat this procedure three times according to the torque table below.

Follow the tightening pattern as shown in the figures below:

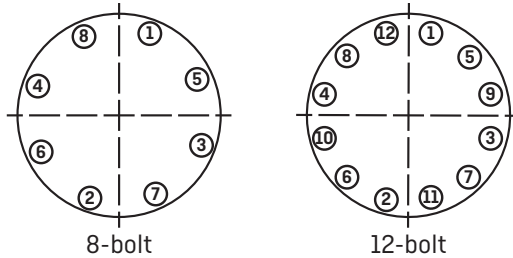

Meter flange Meter size	Bolt size inch	Tightening torque PN16
6"	3/4"	180 ft x lbs
8"	3/4"	180 ft x lbs
10"	7/8"	250 ft x lbs
12"	7/8"	250 ft x lbs

4.3.3 Installing the split flanges on the meter first

- Place the meter vertically on one end
- Fixate the two split flanges together by using a 1/4" bolt
- Place the flange around the meter and close the flange by fixing a second 1/4" bolt in the opposite side
- Turn the meter upside down and install the other split flange

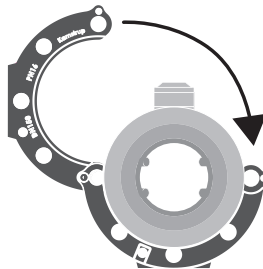

- Lift the meter via the two lifting lugs and lower the meter into place

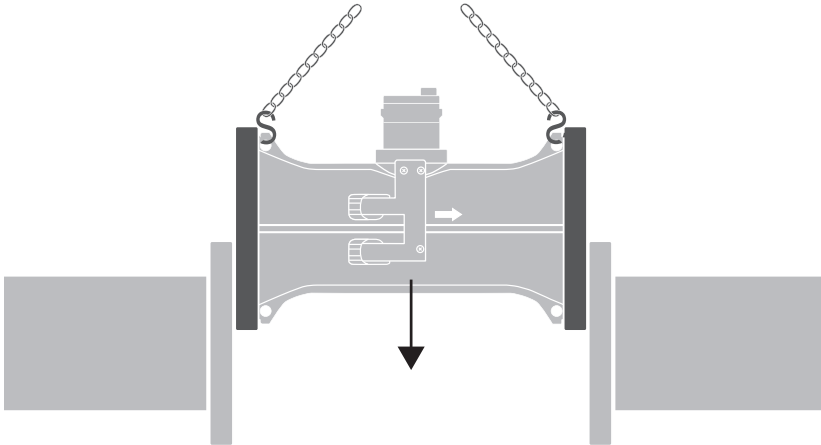

- Mount the two lowest bolts and nuts on each of the two flanges to the pipeline flanges
- Place the new gasket between the meter flanges and the pipeline flanges
- Pre-tighten the remaining bolts and nuts
- Tighten the bolts in the described criss-cross pattern and with the correct tightening torque mentioned in the table
- Repeat the sequence three times to ensure that all bolts are tightened with the correct torque

4.3.4 Installing the flange on the pipeline first

- Fixate the two split flanges by using a ¼" bolt
- Place the below part of the split flange on the below part of the pipeline flange by fixating the two lowest bolts first as shown in the figure below
- Insert the gasket between the flange and the pipeline flange

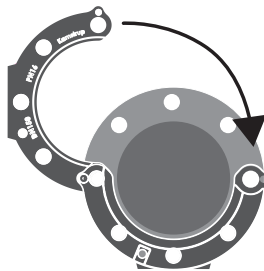

- Repeat the same procedure on the opposite pipeline flange
- Lift the meter via the two lifting lugs and lower the meter into place
- Pre-tighten the remaining bolts and nuts
- Tighten the bolts in the described criss-cross pattern and with the correct tightening torque mentioned in the table
- Repeat the sequence three times to ensure that all bolts are tightened with the correct torque

Note! To enlarge the gasket gap, utilize the pushing nut milling with a bolt and a nut.

4.4 Installation angle

For flowIQ® 4200, it applies that the meter can be mounted at all angles and in all positions.

However, it is recommended to mount the display in such a way that it is easy to read.

4.5 Straight inlet

Normally, the meter requires neither straight inlet nor straight outlet to achieve accurate measurement. However, for installation environments with heavy flow disruptions, several lengths of straight inlets are advisable. This applies to all flange meters.

Note! Cavitation affects the measurement accuracy and may physically damage the meter.

4.6 Flow disturbance and flow cavitation

The components mentioned below can generate heavy flow disruptions or pressure drops:

- Butterfly valve
- Pressure- and flow-regulated components
- Partially closed ball valve
- Pumps in front of the meter
- Pumps after the meter
- Double conjugation in several directions

4.6.1 Service connection

When the meter has been mounted in the system, neither welding nor freezing is allowed. The meter must be dismantled from the system before starting such work.

If the electrical service in the building has been grounded via the plumbing, it must be ensured that adequate electrical ground is maintained both during and after installation.

In order to facilitate replacement of the meter, closing valves should be mounted on both sides of the meter. Under normal operating conditions, a strainer is not required in front of the meter.

5 Encoded output installation

5.1 Remove the protective cap

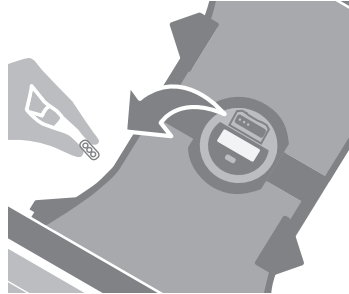
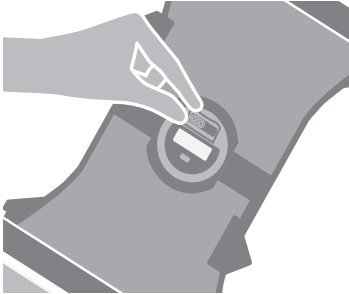

5.2 Mount the plug

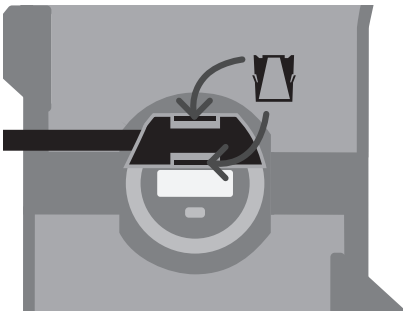
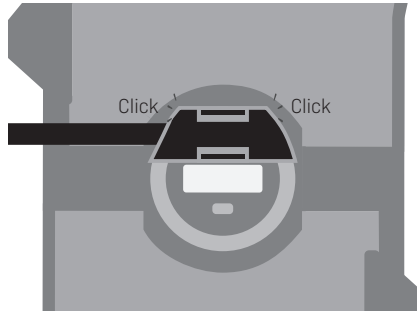
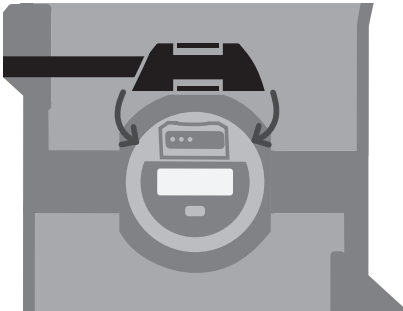

5.3 Connect with other electronic reading systems



Three wire: **Data** GND **PWR/Clock**

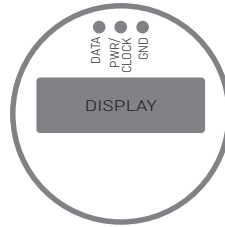

External connection

The reading unit must comply with the electrical requirements of the specification for the Sensus protocol UI 1203R21, September 2014.

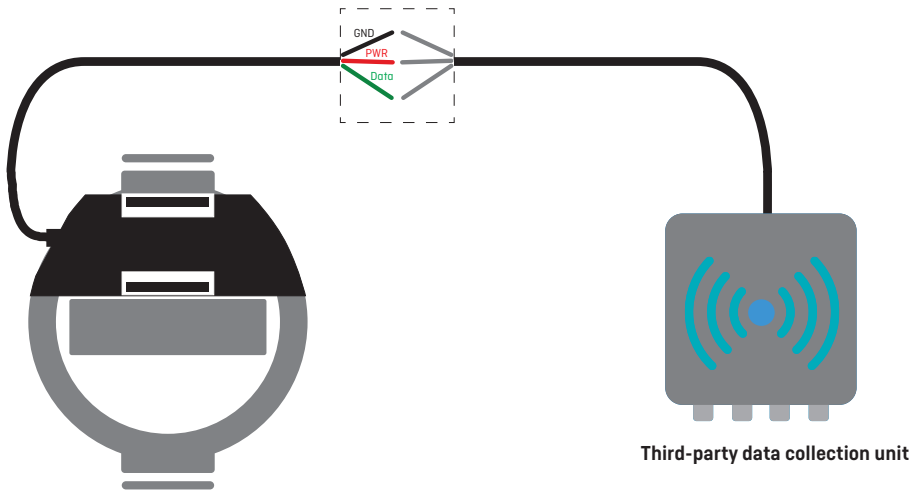

**Kamstrup flowIQ® with module 41
and three wire open ended cable**

Open ended cable compatibility table				
	Sensus	Neptune	Itron #1	Itron #2
Data	Green	Red	Red	Brown
GND	Black	Green	White	Grey
PWR/Clock	Red	Black	Black	Yellow

Third-party color coding refers to those of the data collection unit terminations.

6 FCC Cautions

Caution: Changes or modifications not expressly approved by the party responsible for compliance could void the users authority to operate the equipment.

RF Exposure compliance statement: This device must be installed to provide a separation distance of at least 20 cm from all persons.

This device complies with Part 15 of the FCC Rules.

Operation is subject to the following two conditions:

- 1 This device may not cause harmful interference, and
- 2 This device must accept any interference received, including interference that may cause undesired operation.

This equipment has been tested and found to comply with the limits for a Class B digital device, pursuant to part 15 of the FCC Rules. These limits are designed to provide reasonable protection against harmful interference in a residential installation. This equipment generates, uses and can radiate radio frequency energy and, if not installed and used in accordance with the instructions, may cause harmful interference to radio communications.

However, there is no guarantee that interference will not occur in a particular installation. If this equipment does cause harmful interference to radio or television reception, which can be determined by turning the equipment off and on, the user is encouraged to try to correct the interference by one or more of the following measures:

- Reorient or relocate the receiving antenna.
- Increase the separation between the equipment and receiver.
- Connect the equipment into an outlet on a circuit different from that to which the receiver is connected.
- Consult the dealer or an experienced radio/TV technician for help.

7 ICES/ISED cautions

English:

This device complies with Industry Canada license-exempt RSS standard(s). Operation is subject to the following two conditions:

- (1) This device may not cause interference, and
- (2) This device must accept any interference, including interference that may cause undesired operation of the device.

Complies with the Canadian ICES-003 Class B specifications.

This device complies with RSS 247 of Industry Canada. This Class B device meets all the requirements of the Canadian interference-causing equipment regulations.

This radio transmitter IC ID 22376-KWM4220 has been approved by Innovation, Science and Economic Development Canada to operate with the antenna types listed below, with the maximum permissible gain indicated. Antenna types not included in this list that have a gain greater than the maximum gain indicated for any type listed are strictly prohibited for use with this device.

	Maximum gain:	
Antenna type	450-470 MHz:	902-928 MHz:
Helix	-2 dBi	-2 dBi
Pt, small	-9 dBi	-2 dBi
Wall	1 dBi	-1 dBi

This equipment has been approved for fixed operation, and unless otherwise advised in separate supplemental instructions for individual wireless transmitter(s), requires minimum 20 cm spacing be provided between antenna(s) and all person's body (excluding extremities of hands, wrist and feet) during wireless modes of operation.



Must be installed to provide a separation distance of at least 20 cm from all persons.

Hardware version identification number (HVIN):

02E02G1FR8UB, 02E02G1GA8UB, 02E02G1GJ8UB, 02E02G1GS8UB, 02E02G1FR8FM,
02E02G1GA8FM, 02E02G1GJ8FM, 02E02G1GS8FM

Français:

Cet appareil est conforme aux normes CNR exemptes de licence d'Industrie Canada. Le fonctionnement est soumis aux deux conditions suivantes:

- [1] Cet appareil ne doit pas provoquer d'interférences et
- [2] Cet appareil doit accepter toute interférence, y compris celles susceptibles de provoquer un fonctionnement non souhaité de l'appareil.

Cet appareil numérique de la classe B est conforme à la norme NMB-003 du Canada. Cet appareil est conforme à la norme canadienne RSS 247. Cet appareil numérique de la Classe B respecte toutes les exigences du Règlement sur le matériel brouilleur du Canada.

Cet émetteur radio IC ID 22376-KWM4220 a été approuvé par Innovation, Sciences et Développement économique Canada pour fonctionner avec les types d'antenne énumérés cidessous, avec le gain maximal autorisé indiqué. Les types d'antenne non inclus dans cette liste et ayant un gain supérieur au gain maximum indiqué pour tout type répertorié sont strictement interdits pour l'utilisation avec cet appareil.

	Maximum gain:	
Antenna type	450-470 MHz:	902-928 MHz:
Helix	-2 dBi	-2 dBi
Plt, small	-9 dBi	-2 dBi
Wall	1 dBi	-1 dBi

Cet équipement a été approuvé pour une utilisation fixe et, sauf indication contraire dans les instructions supplémentaires pour émetteurs sans fil individuels, cet équipement nécessite un espace minimum de 20 cm entre l'antenne (s) et le corps de la personne utilisant l'appareil (à l'exclusion des extrémités des mains, des poignets et des pieds) pendant les modes de fonctionnement sans fil.



Doit être installé de façon à respecter une distance de minimum 20 cm à toute personne.

Numéro d'identification de la version de material (NIVM):

02E02G1FR8UB, 02E02G1GA8UB, 02E02G1GJ8UB, 02E02G1GS8UB, 02E02G1FR8FM,
02E02G1GA8FM, 02E02G1GJ8FM, 02E02G1GS8FM

Kamstrup Water Metering, LLC

2855 Forsyth Commerce Way, Building 200

Cumming, GA 30040, USA

T: +1 (404) 835-6716

info-us@kamstrup.com

kamstrup.com